

11 Assembling the Rear Tire

First, assemble each component by following the working method and markings. Then, refer to the illustration and photos below to glue the parts together.

Indication of Working Methods



Fold or Curve



Glue

Rear Tire

Sheet L, 15 parts in total

Fold each relevant part according to the assembly symbols.

Please use the ● dots on each component as reference when gluing surfaces.

*Glue the completed rear wheel to the assembled rear tire.

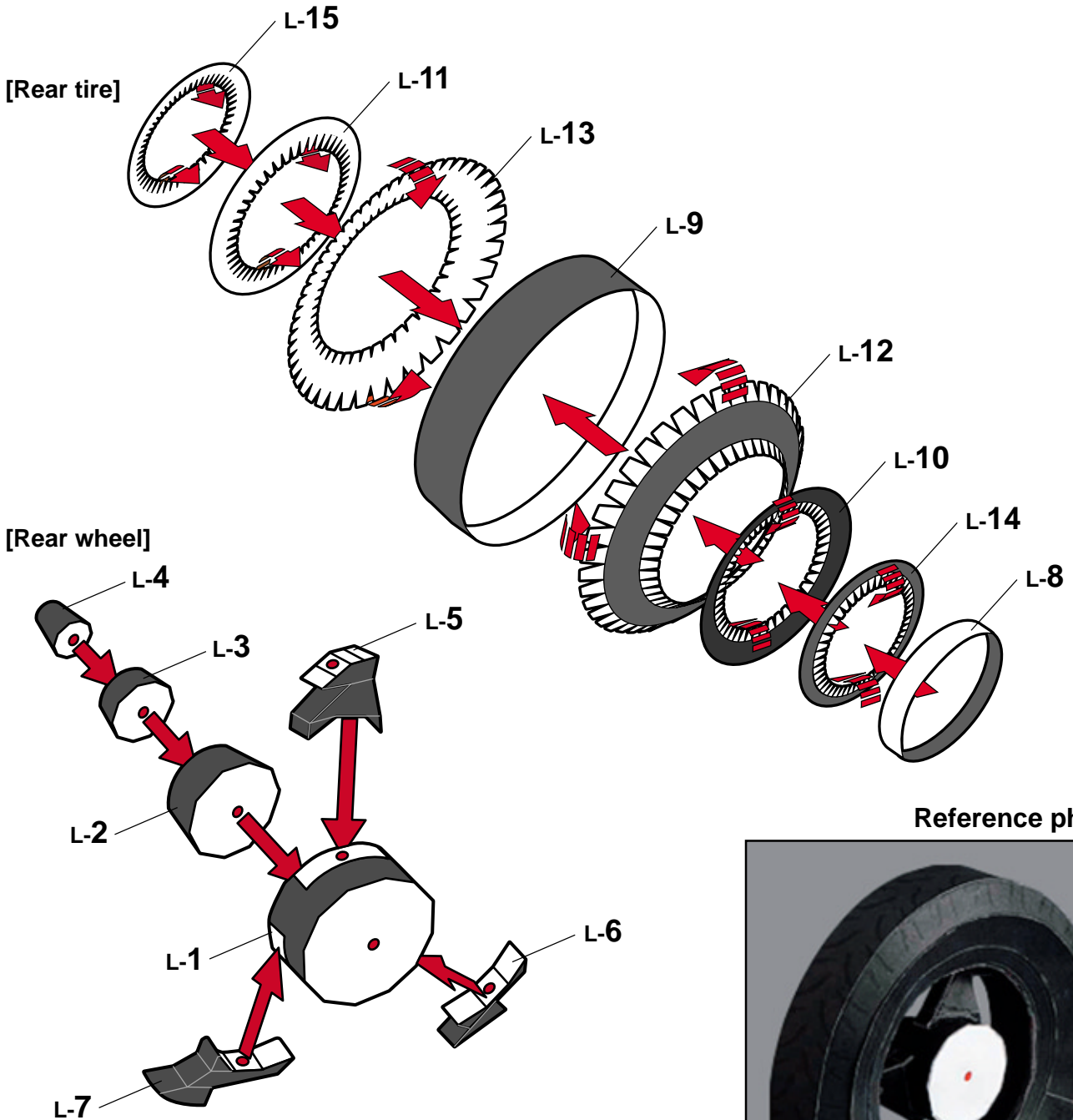

12 Finish

Please use the ● dots on each component as reference when gluing surfaces.

Assembly Instructions

glue the assembled parts in numerical order ① through ⑬.

- ① Glue the side cover B to the frame.
- ② Glue the rear arm to the crankcase.
- ③ Glue the crankcase to the frame.
- ④ Insert the frame into the side cover A, and glue the side covers A and B.
- ⑤ Glue the side cover B to the rear fender.
- ⑥ Glue the exhaust to the crankcase and the rear fender.
- ⑦ Glue the seat to the frame and the rear fender.
- ⑧ Insert the upper steering column into the frame, and glue it to the lower steering column.
- ⑨ Glue the front cowl to the side cover A.
- ⑩ Glue the rear tire to the rear arm.
- ⑪ Glue the front tire to the lower steering column.
- ⑫ Glue the steering handle to the side cover A.
- ⑬ Glue the stand to the crankcase.

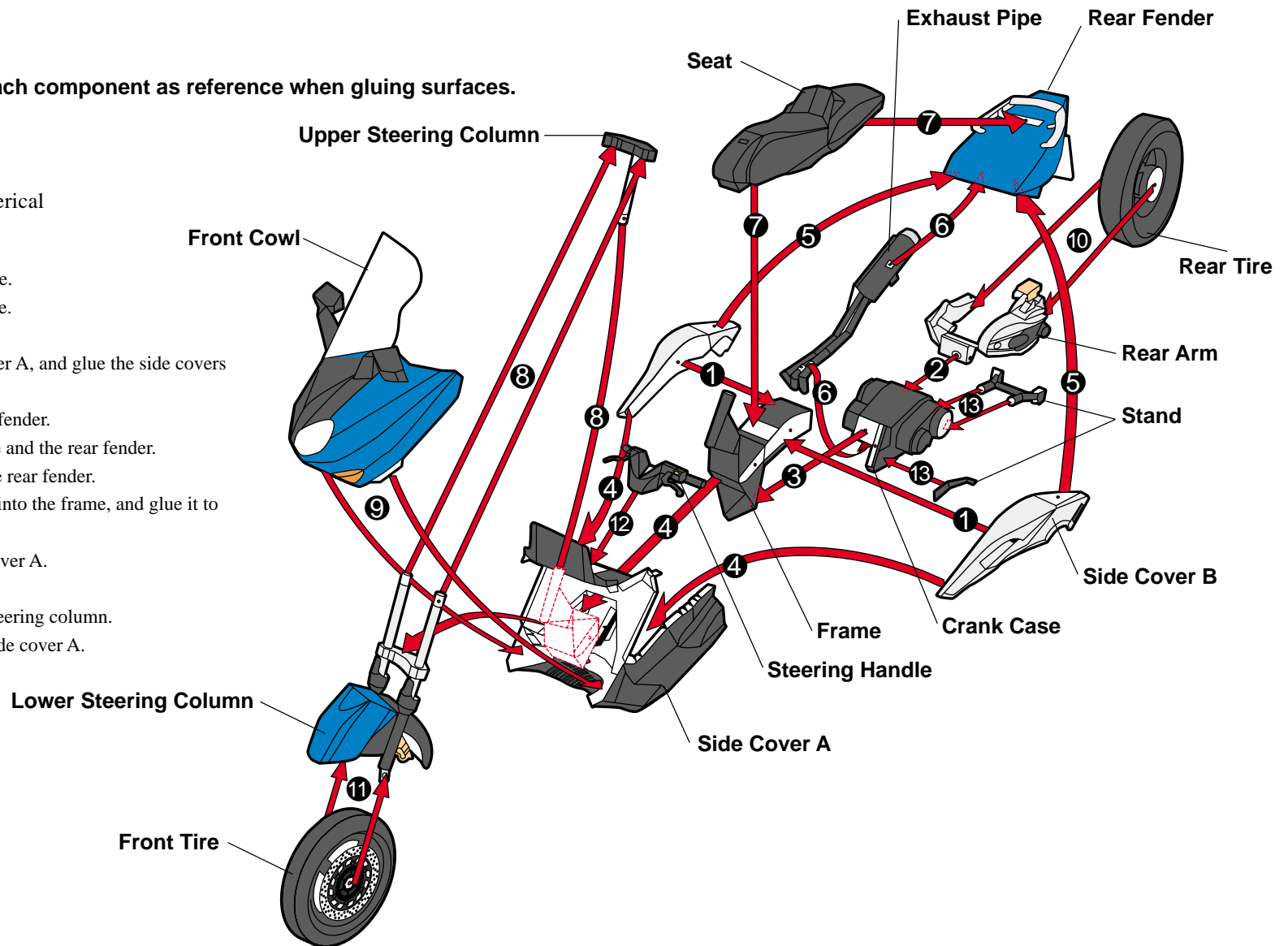

13 Assembled Model and the List of Parts

Please refer to the photo below when attaching each component.

RIGHT

Side Cover

I-1	I-7	I-13	I-19	I-25
I-2	I-8	I-14	I-20	
I-3	I-9	I-15	I-21	
I-4	I-10	I-16	I-22	
I-5	I-11	I-17	I-23	
I-6	I-12	I-18	I-24	

Seat

F-1
F-2
F-3
F-4

Front Cowl

A-1	A-6
A-2	A-7
A-3	
A-4	
A-5	

Rear Tire

L-1	L-6	L-11
L-2	L-7	L-12
L-3	L-8	L-13
L-4	L-9	L-14
L-5	L-10	L-15

Exhaust Pipe

G-1	G-6	G-11	G-16
G-2	G-7	G-12	
G-3	G-8	G-13	
G-4	G-9	G-14	
G-5	G-10	G-15	

Front Tire

K-1	K-6	K-11
K-2	K-7	K-12
K-3	K-8	K-13
K-4	K-9	K-14
K-5	K-10	K-15

Steering

B-1	B-6	B-11
B-2	B-7	B-12
B-3	B-8	B-13
B-4	B-9	B-14
B-5	B-10	

FRONT



14 Assembled Model and the List of Parts

Please refer to the photo below when attaching each component.

LEFT

REAR

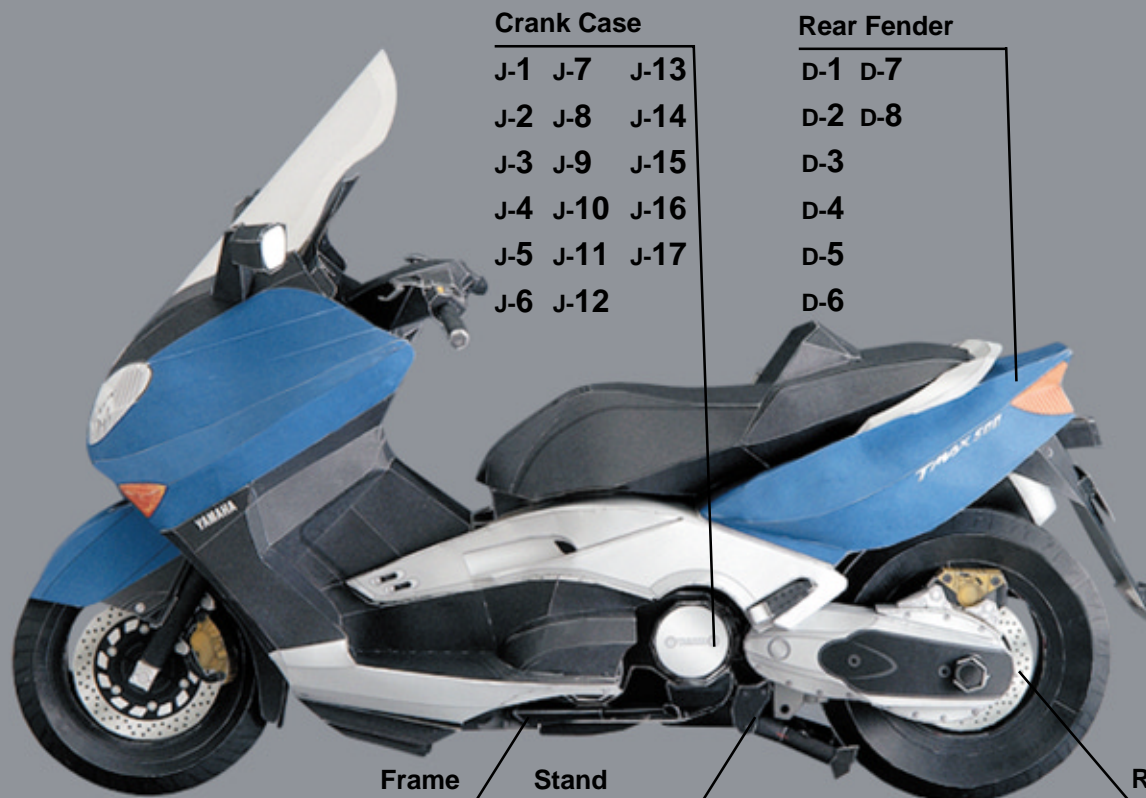

Crank Case

- J-1 J-7 J-13
- J-2 J-8 J-14
- J-3 J-9 J-15
- J-4 J-10 J-16
- J-5 J-11 J-17
- J-6 J-12

Rear Fender

- D-1 D-7
- D-2 D-8
- D-3
- D-4
- D-5
- D-6

Frame

- C-1
- C-2
- C-3
- C-4
- C-5

Stand

- H-8 H-13
- H-9 H-14
- H-10 H-15
- H-11
- H-12

Rear Arm

- E-1 E-6 E-11
- E-2 E-7 E-12
- E-3 E-8 E-13
- E-4 E-9 E-14
- E-5 E-10 E-15

Steering Handle

- H-1 H-6
- H-2 H-7
- H-3
- H-4
- H-5

